



FAST, RELIABLE PERFORMANCE

EC-66 Dishmachine

- ▲ Extended 18" wash section provides consistent results.
- ▲ Separation of wash and rinse sections help prevent water contamination in the final rinse.
- ▲ Machine design provides high throughput, 244 racks per hour.

Leasing a dishmachine from Ecolab allows you to focus on your business with the security of knowing your warewashing operation is properly managed.



LEFT TO RIGHT

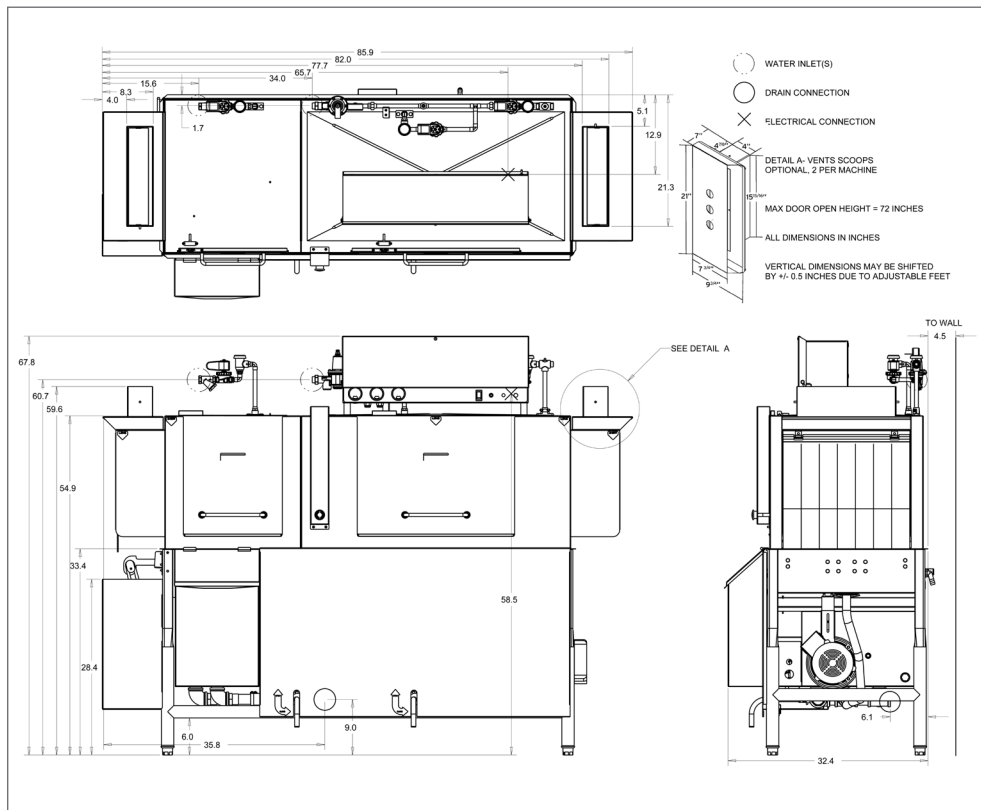

RIGHT TO LEFT

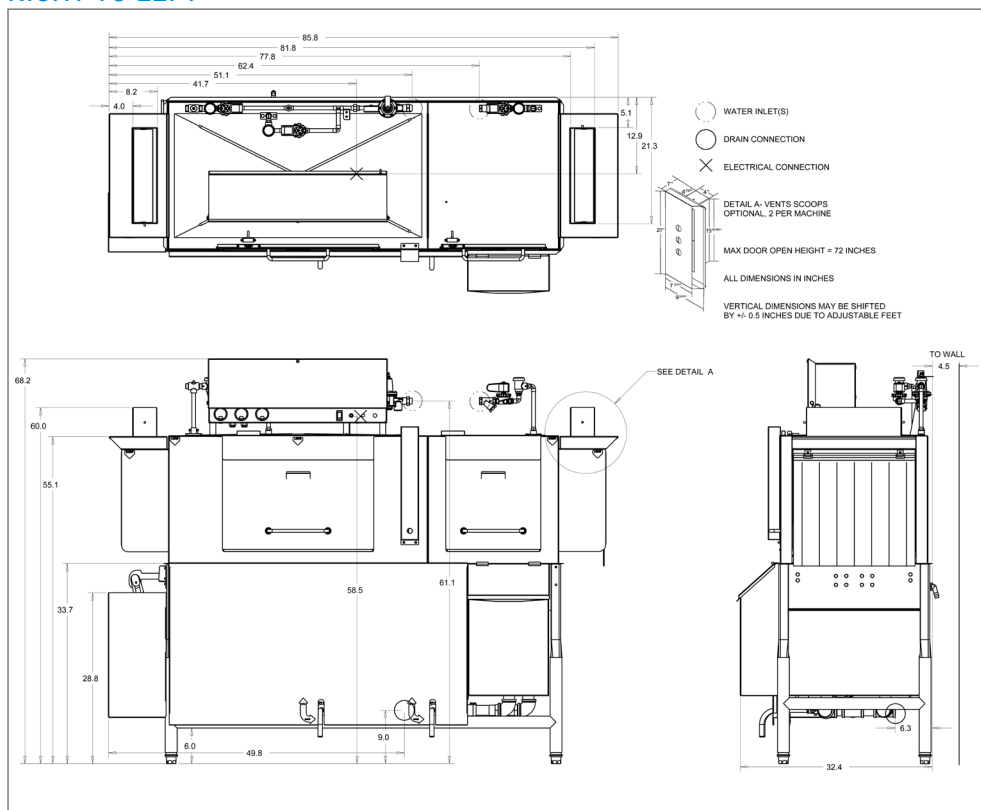

OPERATING CAPACITY

Racks per Hour	244
----------------	-----

OPERATING TEMPERATURES

Wash (min)	
low-temp	140° F
high-temp	160° F

Sanitizing Rinse (min)	
low-temp	120° F
high-temp	180° F

WATER CONSUMPTION

Gallons per Rack	0.91
------------------	------

ELECTRICAL RATINGS

Wash Pump	2 hp
Pre-Wash Pump	1 hp
Drive Motor	1/4 hp

WASH CHAMBER

Internal Height	18"
-----------------	-----

WEIGHT

Machine Weight	872 lbs
----------------	---------

UTILITY REQUIREMENTS ELECTRICAL

Voltage/Frequency/Phase:	
208V/60Hz/3 Ph	
Total Amperage	52.15 A
Typical Electrical Circuit	60 A

Voltage/Frequency/Phase:	
230V/60Hz/3 Ph	
Total Amperage	48.0 A
Typical Electrical Circuit	60 A

Voltage/Frequency/Phase:	
460V/60Hz/3 Ph	
Total Amperage	24.1 A
Typical Electrical Circuit	30 A

Voltage/Frequency/Phase:	
208V/60Hz/1 Ph	
Total Amperage	88.65 A
Typical Electrical Circuit	100 A

Voltage/Frequency/Phase:	
230V/60Hz/1 Ph	
Total Amperage	81.85 A
Typical Electrical Circuit	90 A

WATER

Waterline Size (min)	1/2"
Flow Pressure (required)	15-25 psi
Incoming Temp (min)	
low-temp	120° F
high-temp	180° F
Incoming Temp (recommended)	
low-temp	140° F
high-temp	180° F

DRAIN

Drainline Size	1 1/2"
----------------	--------

VENT HOOD

Flow-Cubic Feet per Minute	600
----------------------------	-----

CHEMICAL SANITIZER RINSE

Minimum chlorine, ppm (low-temp)	50
----------------------------------	----